

HOW WILL YOU ENGAGE WITH YOUR MUSEUM?

Join a drop-in highlights tour. Participate in conversations with curators, scholars, or artists that promote interdisciplinary connections. Sketch in the galleries. Connect with a friend over art at a reception. Enjoy a lunchtime gallery talk or special lecture. Hear faculty perspectives on the collections. Experiment with art materials and discover new ways to think critically about art. Listen to live performances in a stunning setting. Make art alongside your family.

Find more information about upcoming programs and events at hoodmuseum.dartmouth.edu.

ACCESSIBILITY

The museum is fully accessible. Please inquire at the front desk for assistance.

PHOTOGRAPHY

We welcome visitors to photograph works of art owned by the Hood Museum of Art for personal use only. No flash, please, and please do not touch the works of art!

WI-FI

Available through Dartmouth Public.

SHARE YOUR VISIT



#HoodMuseum
@HoodMuseum

BECOME A FRIEND TODAY

The encouragement, contributions, and participation of our Friends help us enrich lives through art. Friends stay up-to-date on our programs and exhibitions, news, and events. It's free and easy to become a Friend: visit "Join and Support" on our website!



Hours

Wednesday, 11:00 am–5:00 pm
Thursday–Friday, 11:00 am–8:00 pm
Saturday–Sunday, 11:00 am–5:00 pm
Closed Monday and Tuesday

Free and open to everyone

HOOD MUSEUM OF ART

Dartmouth College
6 East Wheelock Street
Hanover, New Hampshire 03755

(above) Lathrop Gallery. Photograph © Michael Moran.

(cover) El Anatsui, *Hovor* (detail), 2003, aluminum bottle tops and copper wire. Hood Museum of Art, Dartmouth: Purchased through gifts from the Lathrop Fellows; 2005.42. © El Anatsui

GUIDE

HOOD

WELCOME TO THE HOOD MUSEUM OF ART

We invite you to explore art from cultures across the globe in the new and renovated galleries of the museum. From Asia to Europe and from the Americas to the South Pacific, these dynamic spaces feature favorite and familiar works and introduce new and unexpected ones. Drawn entirely from the museum's collections, this presentation—and a year-long roster of programs—shares our aspiration that direct engagement with art and material culture will inspire creativity and critical thinking as well as offer opportunities for dialogue and unexpected connections across disciplines.

Along with object labels, each gallery offers special labels on the themes of object biography, society and culture, materiality, and objects in dialogue. We hope you find these installations both engaging and inspiring.



Class of 1967 Gallery. Photograph © Michael Moran.

LEVEL 1

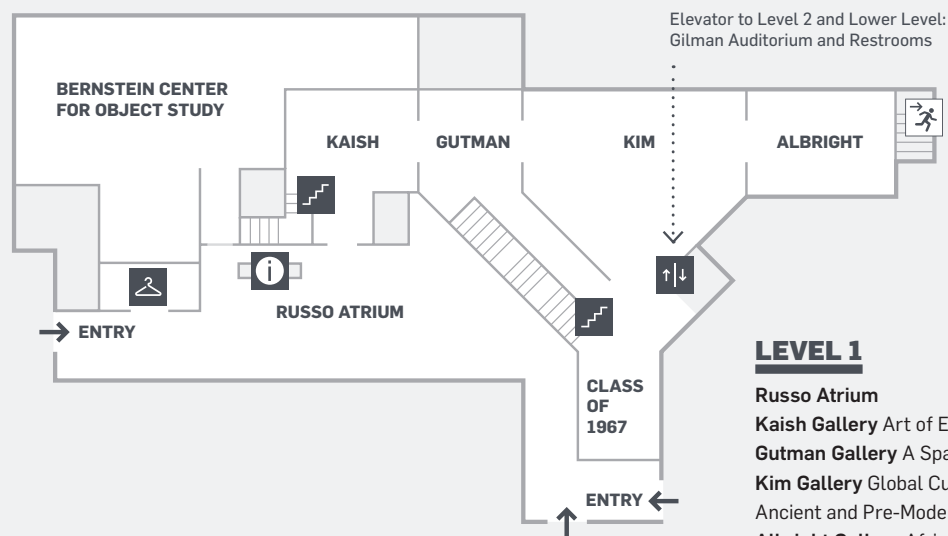

LEVEL 1

- Russo Atrium
- Kaish Gallery Art of Engagement
- Gutman Gallery A Space for Dialogue
- Kim Gallery Global Cultures: Ancient and Pre-Modern Art
- Albright Gallery African Art
- Class of 1967 Gallery Asian Art

LOWER LEVEL

- Gilman Auditorium
- Restrooms

LEVEL 2

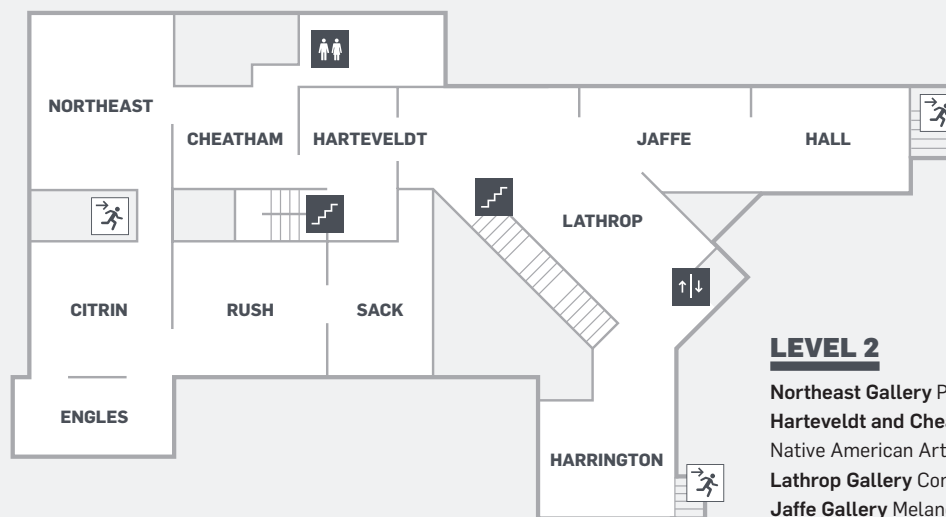

LEVEL 2

- Northeast Gallery Postwar Art
- Harteveldt and Cheatham Galleries Native American Art
- Lathrop Gallery Contemporary Global Art
- Jaffe Gallery Melanesian Art
- Hall Gallery Indigenous Australian Art
- Harrington Gallery European Art
- Sack and Rush Galleries American Art
- Citrin Gallery Transatlantic Modern Art
- Engles Gallery Nineteenth-Century Sculpture

